



**Iron Valley Picnic Table - Surface and Inground Mount.**

- Table Height 29 1/2". Seat Height 24"
- Slats are formed ASTM 1018 cold rolled steel - 1 1/2" x 3/16".
- 4 1/2" Round pipe table base.
- Coated with zinc rich epoxy primer and top coated with electrostatic power coated oven coated.
- Available in surface or inground mount.
- Some assembly required.

**Model #**

KR IVLT 36"/IVBCH 24" 36" Table with 4 Backless Chairs 449 Lbs

KR IVLT 48"/IVBCH 48" Table with 4 Backless Chairs 499 Lbs

KR IVLT 36"/IVCH 36" Table with 4 Chairs 513 Lbs

KR IVLT 48"/IVCH 48" Table with 4 Chairs 513 Lbs

**Frame Finishes**

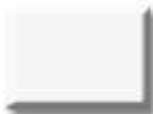

White



Black



Evergreen



Dark Green



Tan



Brown



Blue



Bronze

## IRON VALLEY LUNCH TABLE - 36"

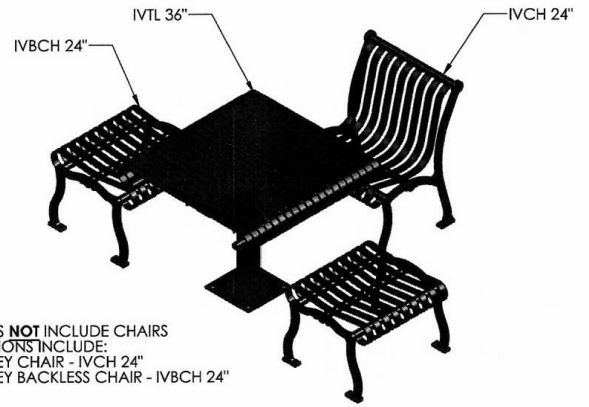
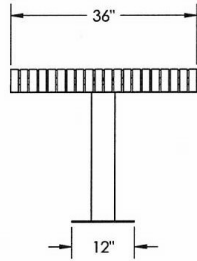
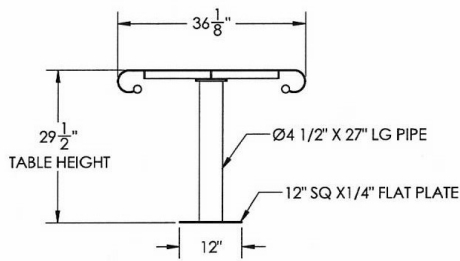

**NOTE:**  
TABLE DOES **NOT** INCLUDE CHAIRS  
CHAIR OPTIONS INCLUDE:  
IRON VALLEY CHAIR - IVCH 24"  
IRON VALLEY BACKLESS CHAIR - IVBCH 24"

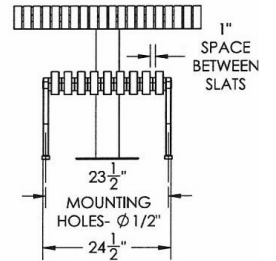
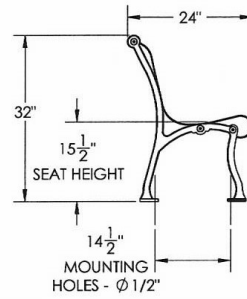
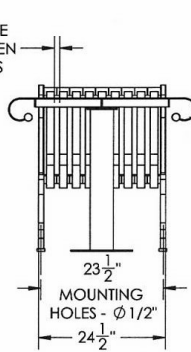
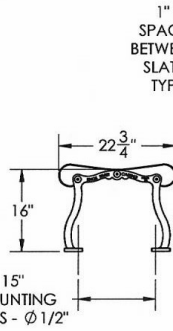
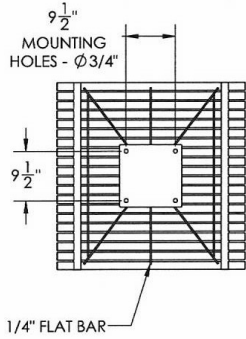

## IRON VALLEY LUNCH TABLE - 48"

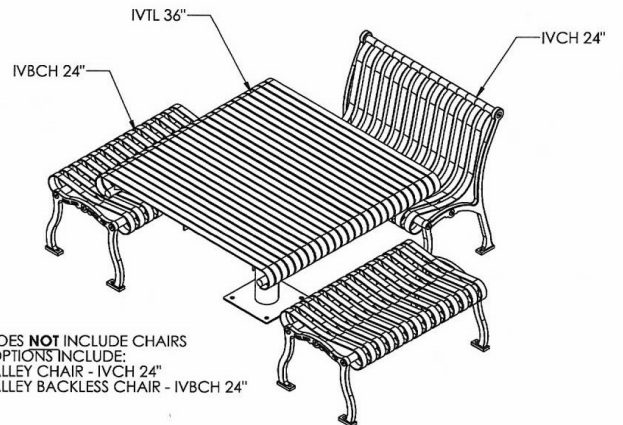
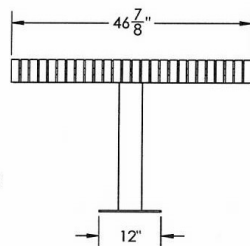
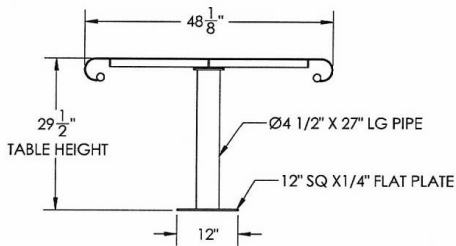

**NOTE:**  
TABLE DOES **NOT** INCLUDE CHAIRS  
CHAIR OPTIONS INCLUDE:  
IRON VALLEY CHAIR - IVCH 24"  
IRON VALLEY BACKLESS CHAIR - IVBCH 24"

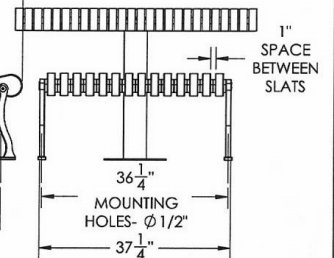
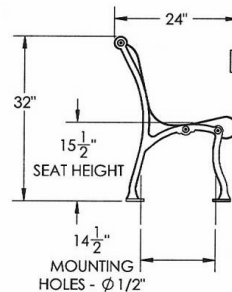
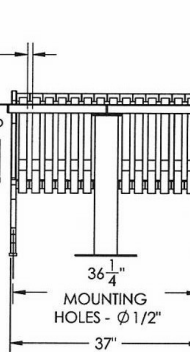
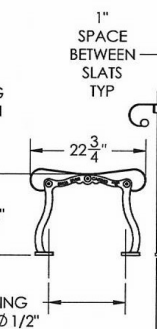
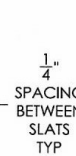
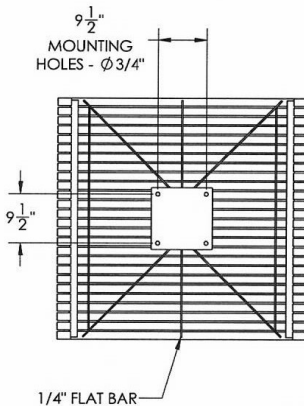

### NATIONAL OUTDOOR FURNITURE, INC.

1210 W. Main Street #296 Riverhead, NY 11901  
Toll-Free Phone: 1-888-663-4621  
Phone: 631-369-9099 Fax: 631-207-8312  
Email: [nofinc@optonline.net](mailto:nofinc@optonline.net)  
[www.nationaloutdoorfurniture.com](http://www.nationaloutdoorfurniture.com)

### NATIONAL OUTDOOR FURNITURE, INC.

144 Murdock Road #325 Pomfret Center, CT 06259  
Toll-Free Phone: 1-888-516-8873  
Phone: 1-860-974-1551 Fax: 516-706-1901  
Email: [nofinc@earthlink.net](mailto:nofinc@earthlink.net)  
[www.nationaloutdoorfurniture.com](http://www.nationaloutdoorfurniture.com)