



### 64 Gallon Animal Resistant Dual Trash Receptacle

- Dimensions: 41 1/2"W x 40"D x 51 1/2"H. 285 Lbs.
- Door hinges are heavy duty stainless steel for superior corrosion resistance and longevity.
- Uses two standard 32 gallon recycle type bag.
- Animal resistant internal single point self latching system on service latch.
- Welded 14 gauge construction.
- 3/16" thick mounts with (4) holes bored to fit 1/2" bolts.
- All exposed corners are chamfered for safety.
- 5 Powder coated colors available for superior corrosion protection.

**Item #:** JTA 13407

### Powder Coated Finishes



**Black**



**Brown**



**Blue**



**Forest Green**



**Gray**

#### **NATIONAL OUTDOOR FURNITURE, INC.**

1210 W. Main Street #296 Riverhead, NY 11901  
Toll-Free Phone: 1-888-663-4621  
Phone: 631-369-9099 Fax: 631-207-8312  
Email: [nofinc@optonline.net](mailto:nofinc@optonline.net)  
[www.nationaloutdoorfurniture.com](http://www.nationaloutdoorfurniture.com)

#### **NATIONAL OUTDOOR FURNITURE, INC.**

144 Murdock Road #325 Pomfret Center, CT 06259  
Toll-Free Phone: 1-888-516-8873  
Phone: 1-860-974-1551 Fax: 516-706-1901  
Email: [nofinc@earthlink.net](mailto:nofinc@earthlink.net)  
[www.nationaloutdoorfurniture.com](http://www.nationaloutdoorfurniture.com)

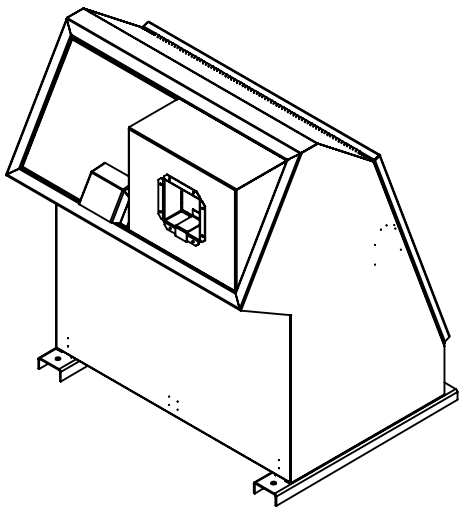

**MODEL 13407**  
**64 GALLON CAPACITY**  
**ANIMAL RESISTANT TRASH/RECYCLE RECEPTACLE**

- Uses two standard 32 gallon recycle type bags.
- ADA compliant.
- Easy access top loading chutes.
- Pivoting bag racks for easy trash removal.

**Mechanical specifications**

- Door hinges are heavy duty stainless steel for superior corrosion resistance and longevity.
  - Animal resistant internal single point self latching system on service hatch.
  - Welded 14 gauge construction.
  - 3/16" thick mounts with (4) holes bored to fit 1/2" bolts.
  - Powder coated for superior corrosion protection.
- Available in forest green, blue, brown, and gray.

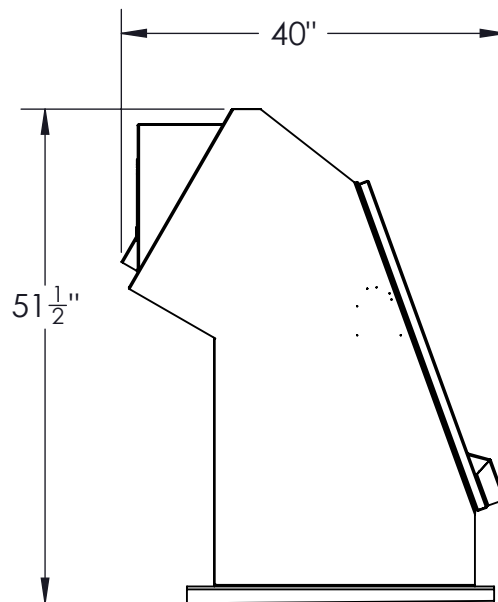
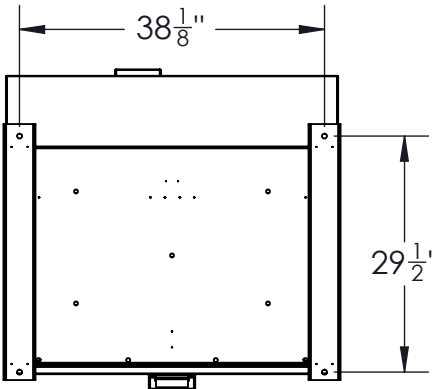
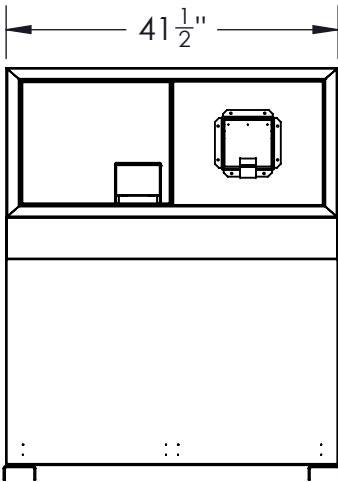

ESTIMATED WEIGHT: 285 LBS