



**4' Recycled Plastic Picnic Table with (4) Attached Seats - Surface /Inground Mount.**

- 320 lbs.
- 48" Square table top x 28 3/8" High.
- Made with nine 2" x 10" recycled plastic slats and black powder coated steel base.
- Includes a UV protectant.
- Surface mounting wedge anchors included.
- Available in green, cedar, gray and brown with black powdercoated steel base.
- With umbrella hole.
- Some assembly required.
- Also available with (3) seats - ADA.

**Item #:** JP PB4BFSPIC

## Resinwood Slat Colors



Cedar



Brown



Gray

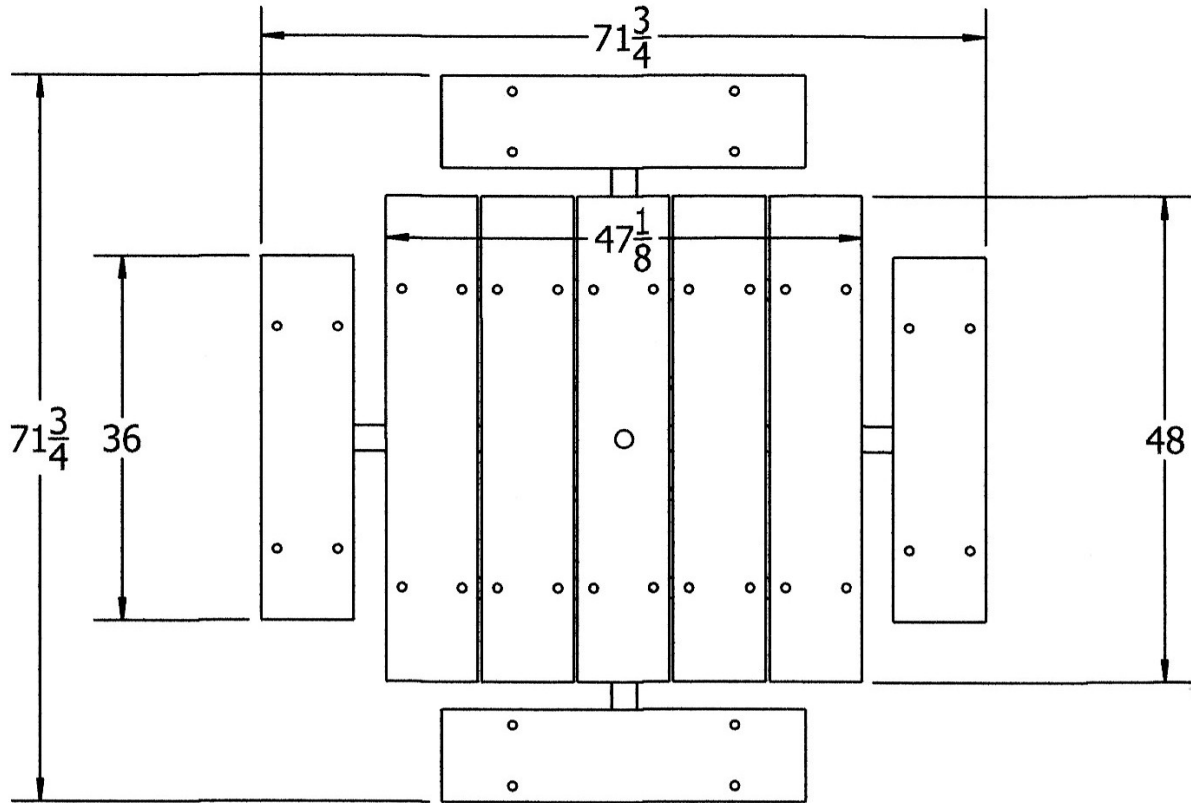

TOP VIEW

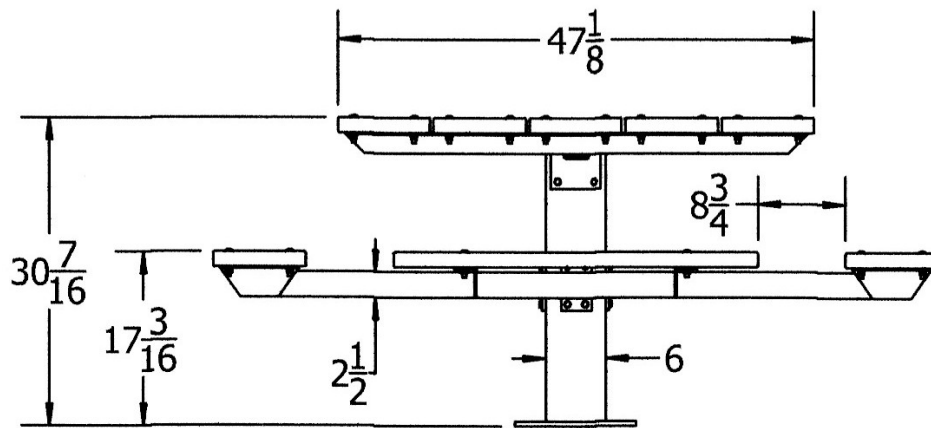

FRONT/SIDE VIEW

**NATIONAL OUTDOOR FURNITURE, INC.**  
 1210 W. Main Street #296 Riverhead, NY 11901  
 Toll-Free Phone: 1-888-663-4621  
 Phone: 631-369-9099 Fax: 631-207-8312  
 Email: [nofinc@optonline.net](mailto:nofinc@optonline.net)  
[www.nationaloutdoorfurniture.com](http://www.nationaloutdoorfurniture.com)

**NATIONAL OUTDOOR FURNITURE, INC.**  
 144 Murdock Road #325 Pomfret Center, CT 06259  
 Toll-Free Phone: 1-888-516-8873  
 Phone: 1-860-974-1551 Fax: 516-706-1901  
 Email: [nofinc@earthlink.net](mailto:nofinc@earthlink.net)  
[www.nationaloutdoorfurniture.com](http://www.nationaloutdoorfurniture.com)