

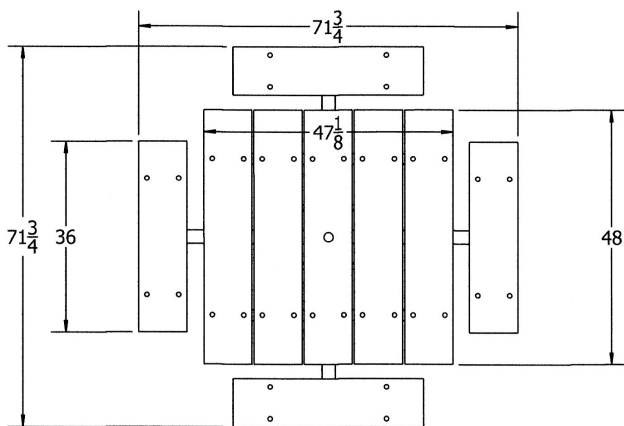

**4' Recycled Plastic Picnic Table with (4) Attached Seats - Surface /Inground Mount.**

- 320 lbs.
- 48" Square table top x 28 3/8"High.
- Made with nine 2" x 10" recycled plastic slats and black powder coated steel base.
- Includes a UV protectant.
- Surface mounting wedge anchors included.
- Available in green, cedar, gray and brown with black powdercoated steel base.
- With umbrella hole.
- Some assembly required.
- Also available with (3) seats - ADA.

**Item #:** JP PB4BFSPIC



TOP VIEW

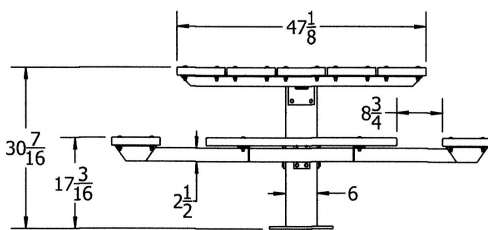

FRONT/SIDE VIEW

## Resinwood Slat Colors



Cedar



Green



Gray



Brown



National Outdoor Furniture  
1210 W. Main Street #296  
Riverhead, N.Y. 11901

PHONE (888) 663-4621  
E-MAIL [nofinc1@gmail.com](mailto:nofinc1@gmail.com)

[www.nationaloutdoorfurniture.com](http://www.nationaloutdoorfurniture.com)